

G304 (G-Type)

Subminiature Micro Switch



■ Features

- Designed for water and dust tight (IP67)
- Small compact size
- Long life and high reliability
- Variety of levers
- Wide range of wiring terminals
- Widely used in automotive electronics, appliances and industrial control etc.
- Customized designs
- Slide structure
- Non short circuit conversion

■ Application

- ◆ Car
- ◆ Air-conditioner
- ◆ Communication
- ◆ Electric toothbrush
- ◆ Toys

■ Parameters

Operation Speed		1~500mm/s
Operating Frequency		120 cycles/min.
Insulation Resistance		≥100MΩ
Contact Resistance (Initial Value)	With terminals type	≤100mΩ
	With wires type	≤500mΩ (Standard wire length 300mm)
Voltage Resistance	Between terminals	AC500V, 50/60Hz, 1min.
	Between terminals and uncharged metal parts	AC1000V, 50/60Hz, 1min.
Vibration	No transformation action	10-55Hz (Double amplitude 1.5mm)
Service Life	Electrical	300,000 cycles (15 cycles/min.) DC12V 0.1A DC3V 50μA
	Mechanical	300,000 cycles (30 cycles/min.)
Protection Level		IEC IP67 (Except terminals)
Operating Temperature		-40~+85°C 60%RH Max. (No icing, no condensation)
Operating Humidity		95%RH Max. (+5~+35°C)

G304G-Type Series Micro Switch Ordering Instruction

G3	04G	150	U		00	E	39	
Switch Type	Electrical Rating	Operating Force at Pin Plunger	Terminal Type		Lever Type	Circuitry	Shape and Posts	Posts Dimension
G3 Series - Micro Switch	0.1A 12VDC 50uA 3VDC	80 80gf Max.	U Left-right PCB Terminals	G Type Left Side PCB Terminals	00 No Lever Pin Plunger	E Slide Type SPST-NO 1, 2	39 G Type W/O Post	Standard Posts:2.60mmx5.0mm
	... Other	150 150gf Max.	V Solder Terminals 6# 7#	G Type Left Solder Terminals	... Other	F Slide Type SPST-NC 1, 2	40 G Type Left Posts	G Φ2. 6x1.5mm Posts.
		... Other	M Short Solder Terminals 6# 7#	G Type Short Solder Terminals		... Other	41 G Type Right Posts	H Φ2. 6x2.0mm Posts.
			P Straight PCB Terminals	G Type Straight PCB Terminals			42 G Type Two Sides Posts	I Φ2. 2x0.8mm Posts.
			S 2.0 Short Solder Terminals with Hole# 2.0	G Type Short Solder Terminals with Holes			44 G Type Revers Left Posts	K 7.3x1.2x1.2mm Posts.
			... Other			48 G Type Rectangle one Side Posts	... Other	
						... Other		

G	A	280	B	T001	U
AWG Type(For wire type only)	AWG Number (For wire type only)	Wire Length	Type of Wire Outline	Custom Code	LOGO
W/O Molded Lead Wires	W/O Molded Lead Wires	300mm Length Standard Lead Wires 300mm	B Molded Lead Wires on Left Side	General	U Unionwell
... Other	A UL1007	280 280mm Length	C Molded Lead Wires on Right Side	T001 Customized according to requirements, the code format is T+serial number XXX, for example: T001	... Other
	C UL1430	... Other	E Molded Lead Wires on Bottom	... Other	
	D UL1061		... Other		
	E UL1330				
	F AVSS				
	H UL1332				
	G UL3132				
	... Other				

Unionwell

■ Circuit

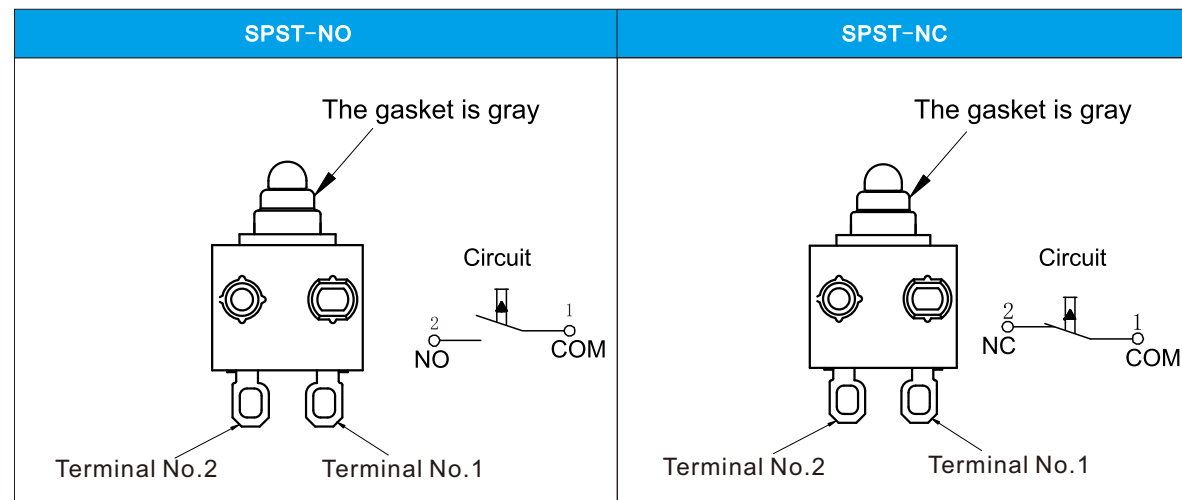

■ Post direction define

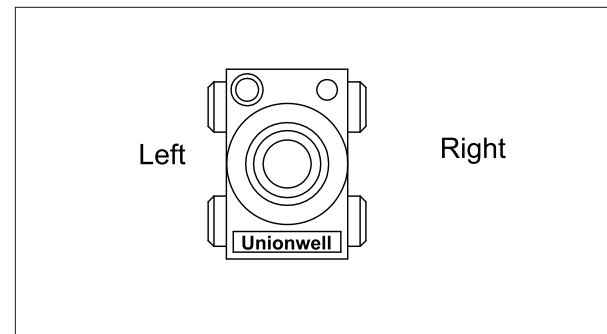

■ Basic Mounting Dimensions and Operating Characteristics

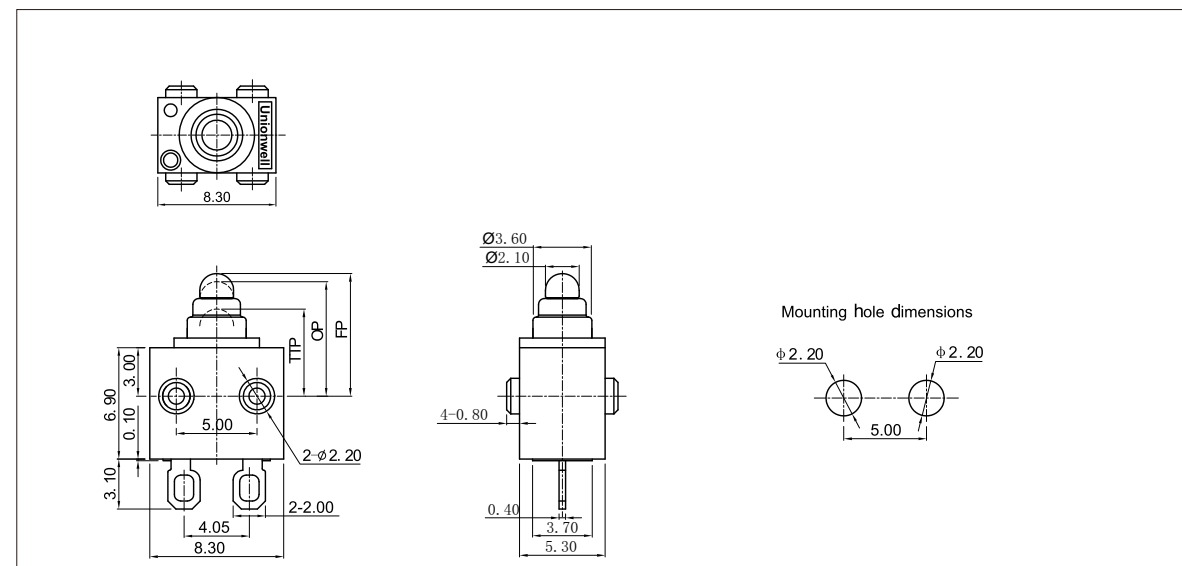

Unionwell

■ Switch Terminal Type (can be customized)

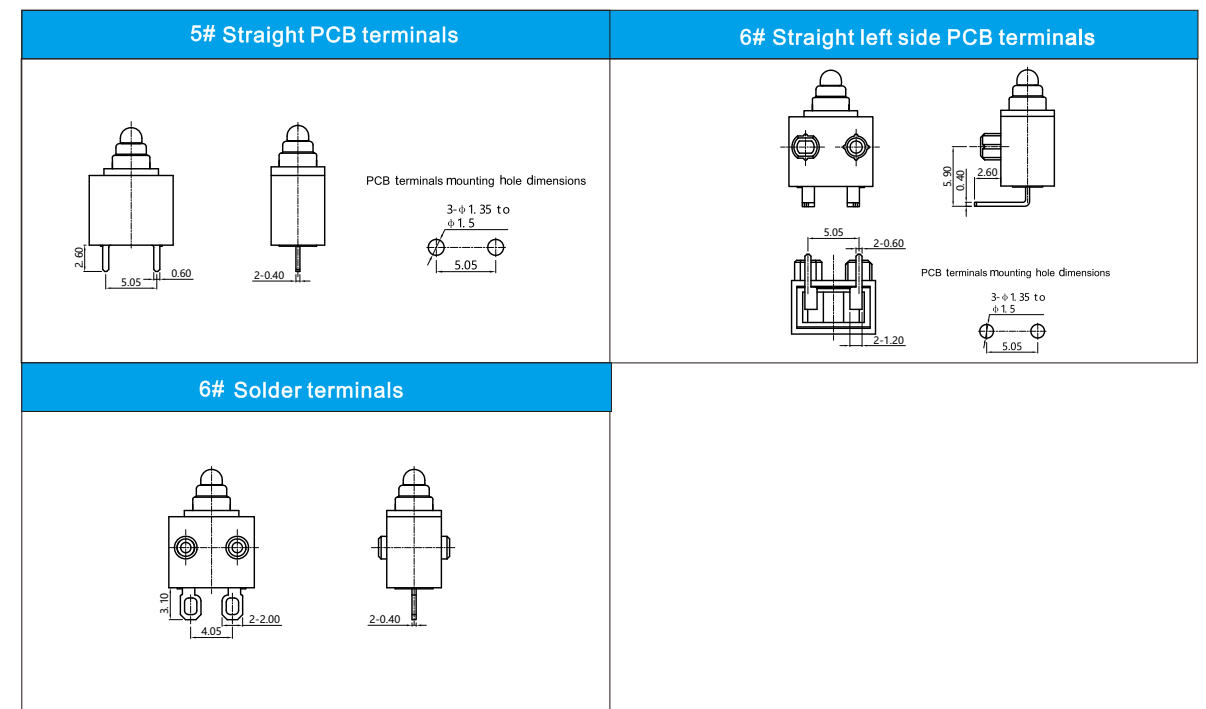

■ Posts Type

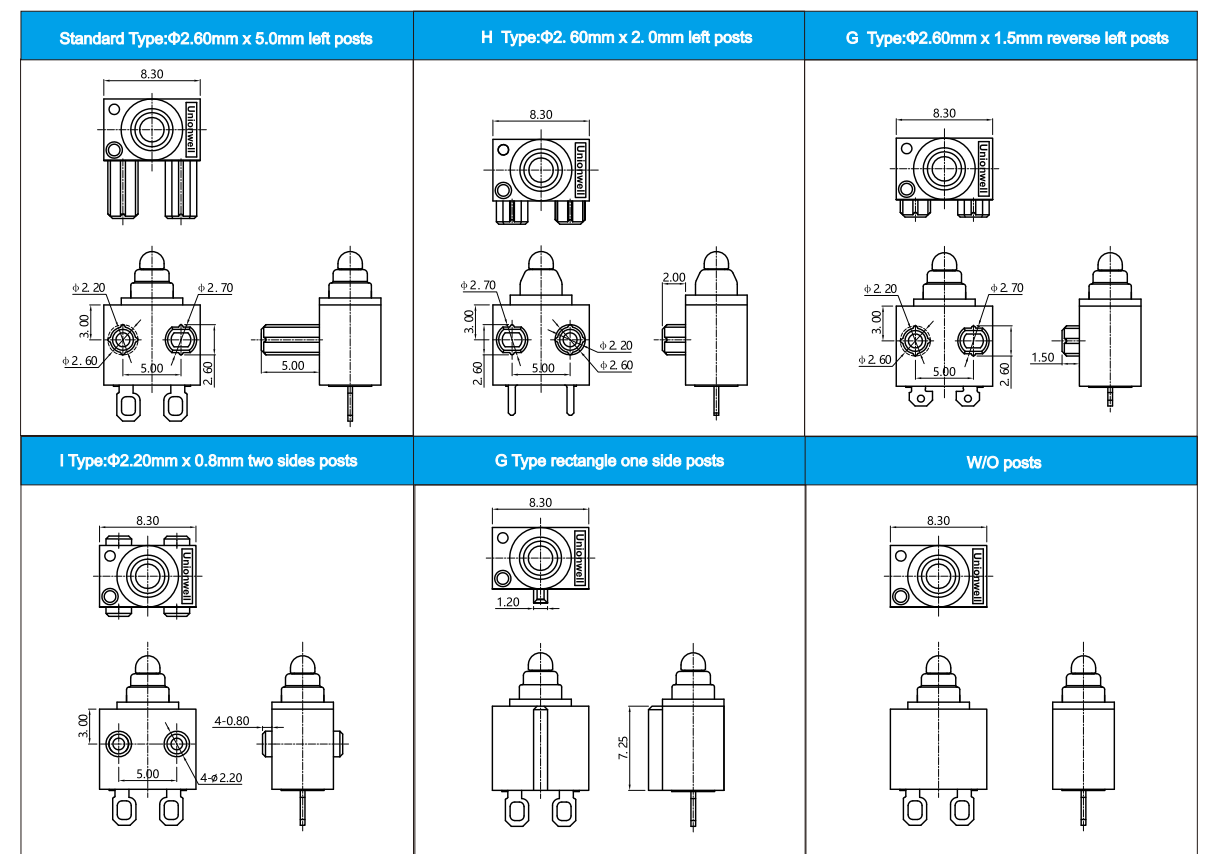

■ Dimensions and Operating Characteristics

◆ G304G-150U00E40HU

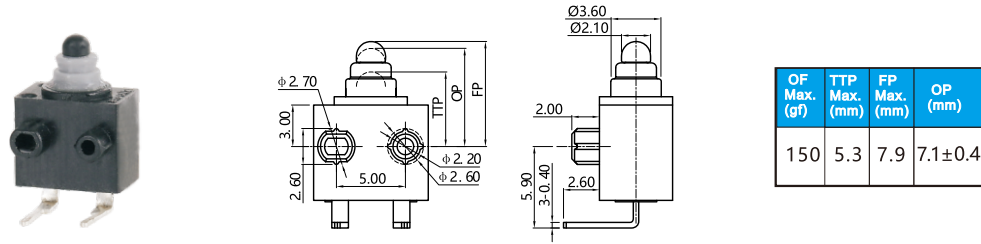

◆ G304G-150V00F44GU

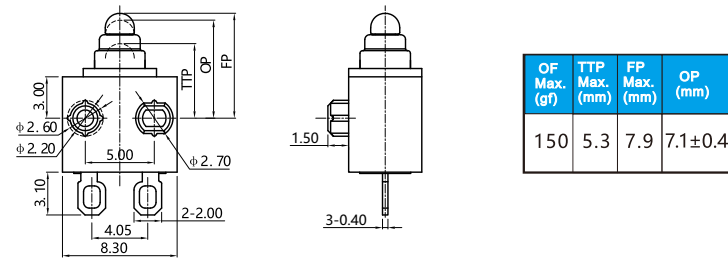

◆ G304G-150M00E48-□□□□□BU

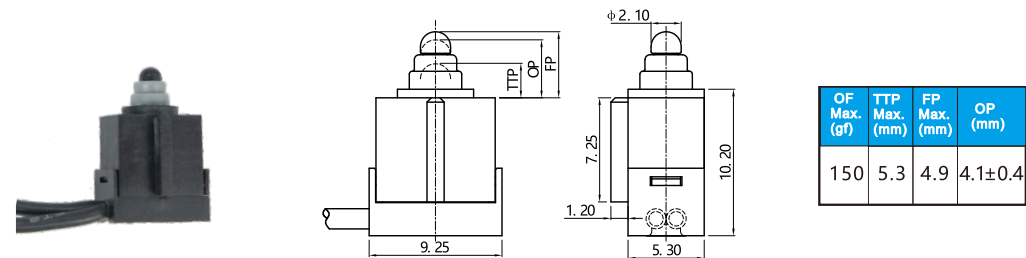

◆ G304G-150M00E40H-□□□□□CU

